



300 HUEY LENARD LOOP | WEST MONROE | LA 71292  
 OFFICE: 318-397-3000 | FAX: 318-397-3040  
 SERVICE & TECH SUPPORT: 800-551-4955  
 SUPERLIFT.COM



# 2018-2020 JEEP WRANGLER JL 2020-2020 JEEP GLADIATOR JT WITH 1.5" LIFT OR HIGHER Dual Steering Stabilizer Kit INSTALLATION INSTRUCTIONS

Engineered for 4WD Models.

Fits: 2020-2020 Jeep JT GLADIATOR 4WD

2018-2020 Jeep Wrangler JL Sport 2-Door 4WD

2018-2020 Jeep Wrangler JL Sport S 2-Door 4WD

2018-2020 Jeep Wrangler JL Rubicon 2-Door 4WD

2018-2020 Jeep Wrangler JL Unlimited Sport 4-Door 4WD

2018-2020 Jeep Wrangler JL Unlimited Sport S 4-Door 4WD

2018-2020 Jeep Wrangler JL Unlimited Sahara 4-Door 4WD

2018-2020 Jeep Wrangler JL Unlimited Rubicon 4-Door 4WD

2019-2020 Jeep Wrangler JL Unlimited Moab 4-Door 4WD



**CAUTION:** MAKE SURE YOU HAVE THE CORRECT PRODUCT FOR YOUR VEHICLE:

Double check the Year, Make, Model, Lift Height and KIT Part Numbers.

**NOTE:** Prior to beginning the installation, OPEN the Boxes and CHECK the Included Components Compared to the Parts Breakdown. Check all parts and hardware in the box with the parts list below. Be sure you have all needed parts and know where they install.

If you find a packaging error, contact SUPERLIFT directly. Do not contact the dealer where the system was originally purchased. You will need the control number from each box when calling; this number is located at the bottom of the part number label and to the right of the bar code.



**How to Read the Kit Breakdown Charts:**

The 'K KIT BREAKDOWN' lists the Part Numbers, Quantities & Part Description of the Boxes that are included in the K KIT. The 'KIT BREAKDOWN' lists Part Numbers, Quantities & Part Description of the Individual Components & Hardware Bags that are included in Each Box. The 'HARDWARE BREAKDOWN' lists the Part Numbers, Quantities & Part Description of the Individual Components.

KIT BREAKDOWN		
Kit Part Number 92715		
Part Number	Qty.	Description
55-01-5800	1	JT-JL Dual Steering Stabilizer Bracket: Center
55-03-5800	1	JT-JL Dual Steering Stabilizer Bracket: Driver
55-04-5800	1	JT-JL Dual Steering Stabilizer Bracket: Passenger
24-158428	2	BILSTEIN Steering Stabilizer
77-92715	1	Hardware Bag: Kit

HARDWARE BREAKDOWN		
Kit Part Number 77-92715		
Part Number	Qty.	Description
01-60450	2	Sleeve: 0.625-ODx0.504-IDx1.48-Length
12C5NN	4	1/2" Nyloc Nut, Coarse Thread
12CW	2	1/2" F436 Carbon Washer
12X234C5CB	4	1/2" x 2-3/4" Carriage Bolt, Coarse Thread, Grade 5
12SW	8	1/2" SAE Flat Washer
12X278X5UB	1	1/2" x 2-7/8" x 5" U-Bolt
1511-B08	2	1/2"-20 Hi Nut
516C5SFLN	8	5/16" Flange Nut, Coarse Thread, Grade 5
5/16X158X214UB	4	5/16" x 1-5/8" x 2-1/4" U-Bolt

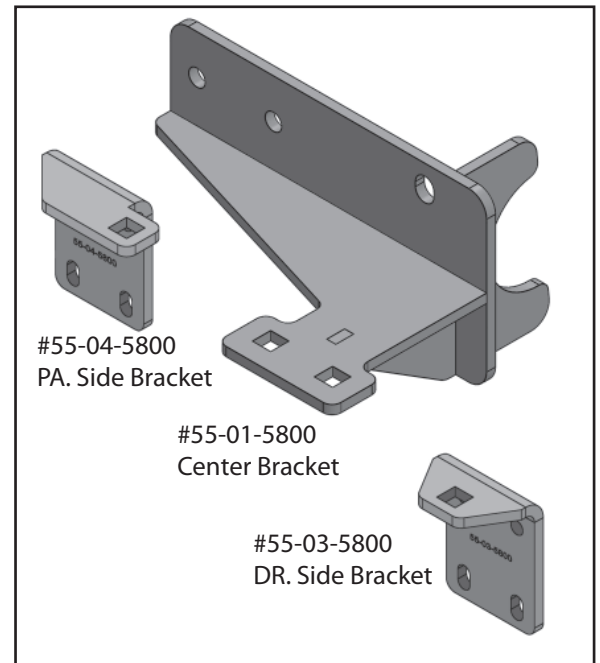

Step	Part Number	Qty. Per Kit	Description	New Attaching Hardware	Qty. Per Bracket	Hardware Bag Number
4	55-01-5800	1	Center Bracket	1/2" x 2-7/8" x 5" U-Bolt	1	77-92715
				1/2"-20 Hi Nut	2	
				1/2" F436 Carbon Washer	2	
				1/2" x 2-3/4" Carriage Bolt, Coarse Thread, Grade 5	2	
				1/2" SAE Flat Washer	4	
				1/2" Nyloc Nut, Coarse Thread	2	
5	55-04-5800	1	Passenger Side, Outside Bracket	5/16" x 1-5/8" x 2-1/4" U-Bolt	2	77-92715
				5/16" Flange Nut, Coarse Thread, Grade 5	4	
				1/2" x 2-3/4" Carriage Bolt, Coarse Thread, Grade 5	1	
				1/2" SAE Flat Washer	2	
				1/2" Nyloc Nut, Coarse Thread	1	
5	55-03-5800	1	Driver Side, Outside Bracket	5/16" x 1-5/8" x 2-1/4" U-Bolt	2	77-92715
				5/16" Flange Nut, Coarse Thread, Grade 5	4	
				1/2" x 2-3/4" Carriage Bolt, Coarse Thread, Grade 5	1	
				1/2" SAE Flat Washer	2	
				1/2" Nyloc Nut, Coarse Thread	1	
6	24-158428	2	BILSTEIN Stabilizer			

# THANK YOU For Choosing SUPERLIFT For ALL Your Suspension Needs!

## Read And Understand All Instructions And Warnings Prior To Installation Of System AND Operation Of Vehicle.

### INTRODUCTION BEFORE INSTALLATION...

Installation requires a professional mechanic. In addition to these instructions, professional knowledge of disassembly / reassembly procedures and post installation checks must be known.

PRIOR to beginning, inspect the vehicles steering, driveline, and brake systems, paying close attention to the suspension link arms and bushings, sway bars and bushings, tie rod ends, pitman arm, idler arm, ball joints and wheel bearings. Also check the steering sector-to-frame and all suspension-to-frame attaching points for stress cracks. The overall vehicle must be in excellent working condition; repair or replace all worn parts.

Read instructions several times before starting.

Read each step completely as you go.

**Be sure you have all needed parts and know where they install.**

### NOTES:

- A foot-pound torque specification reading is given in parenthesis ( ) after each appropriate fastener.
- Tool and Wrench/Socket size is given in brackets [ ] after each appropriate step.
- Always wear safety glasses when using power tools.
- Prior to attaching components, be sure all mating surfaces are free of grit, grease, excessive undercoating, etc.
- Do not fabricate any components to gain additional suspension height.
- A factory service manual should be on hand for reference.

### BEFORE YOU DRIVE...

Check all fasteners for proper torque. Check to ensure for adequate clearance between all rotating, mobile, fixed, and heated members. Verify clearance between exhaust and brake lines, fuel lines, fuel tank, floor boards and wiring harness. Check steering components for clearance.

Test and inspect brake system. Perform steering sweep to ensure front brake hoses have adequate slack and do not contact any rotating, mobile or heated members. Inspect rear brake hoses at full extension for adequate slack. Failure to perform hose check/replacement may result in component failure.

Perform head light check and adjustment.

** WARNING:** It is the ultimate buyer's responsibility to have all bolts / nuts checked for tightness after the first 100 miles and then every 1000 miles. The steering, suspension and driveline systems, plus wheel alignment should be inspected by a qualified professional mechanic at least every 3000 miles.

### TOOLS & TECH...

This is a list of tools needed to install this lift kit. Double check the list to make sure that you have all the tools and equipment required to accomplish the complete install.

We have also included a **Tech Tip** noted by this icon  **TECH TIP** to help if we have found a quicker or easier way to accomplish a task in the steps.

Tools			
Miscellaneous Tools		Wrench / Socket Sizes	
Floor Jacks	Jack Stands	Standard	Metric
		1/2"	13mm
		3/4"	18mm

Torque Specifications					
STANDARD			METRIC		
Size	Grade 5	Grade 8	Size	Grade 8.8	Grade 10.9
5/16"	15 ft/lbs.	20 ft/lbs.	6mm	7 ft/lbs.	10 ft/lbs.
3/8"	30 ft/lbs.	35 ft/lbs.	8mm	17 ft/lbs.	24 ft/lbs.
7/16"	45 ft/lbs.	60 ft/lbs.	10mm	33 ft/lbs.	47 ft/lbs.
1/2"	65 ft/lbs.	90 ft/lbs.	12mm	59 ft/lbs.	83 ft/lbs.

**NOTE:** Use the check-off box  found at each step to help you keep your place. Two  denotes that one check-off box is for the Driver Side (Left) and one is for the Passenger Side (Right). Unless otherwise noted, always start with the Driver Side.

## INSTALLATION PROCEDURE

**NOTE:** Retain all factory components and hardware for reuse, unless otherwise specified.

### 1. PREPARE VEHICLE...

Position the vehicle on a level surface with the front tires pointing straight ahead. Put the vehicle in Park or First (1<sup>st</sup>) gear, set the emergency brake, and chock the rear wheels to prevent any possibility of movement. The vehicle should remain on the ground with the suspension "loaded" at normal operating weight to reflect the true ride height.

### 2. REMOVE FACTORY STABILIZER...

**[Illustration 1-A]** Remove the factory steering stabilizer cylinder. Remove the stabilizer mounting bolt from the factory bracket at the tie rod end on the passenger side. [18mm]

**[Illustration 1-B]** Remove the stabilizer mounting bolt from the factory bracket at the center axle. [18mm] Remove the factory steering stabilizer cylinder..

**[Illustration 1-C]** Remove the two (2) upper mounting bolts from the center axle bracket. [13mm] Retain bolts for reuse.

**[Illustration 1-D]** Remove the side mounting bolt from the center axle bracket. [13mm]

### Illustration 1

#### Remove Factory Stabilizer & Axle Mounting Bracket...

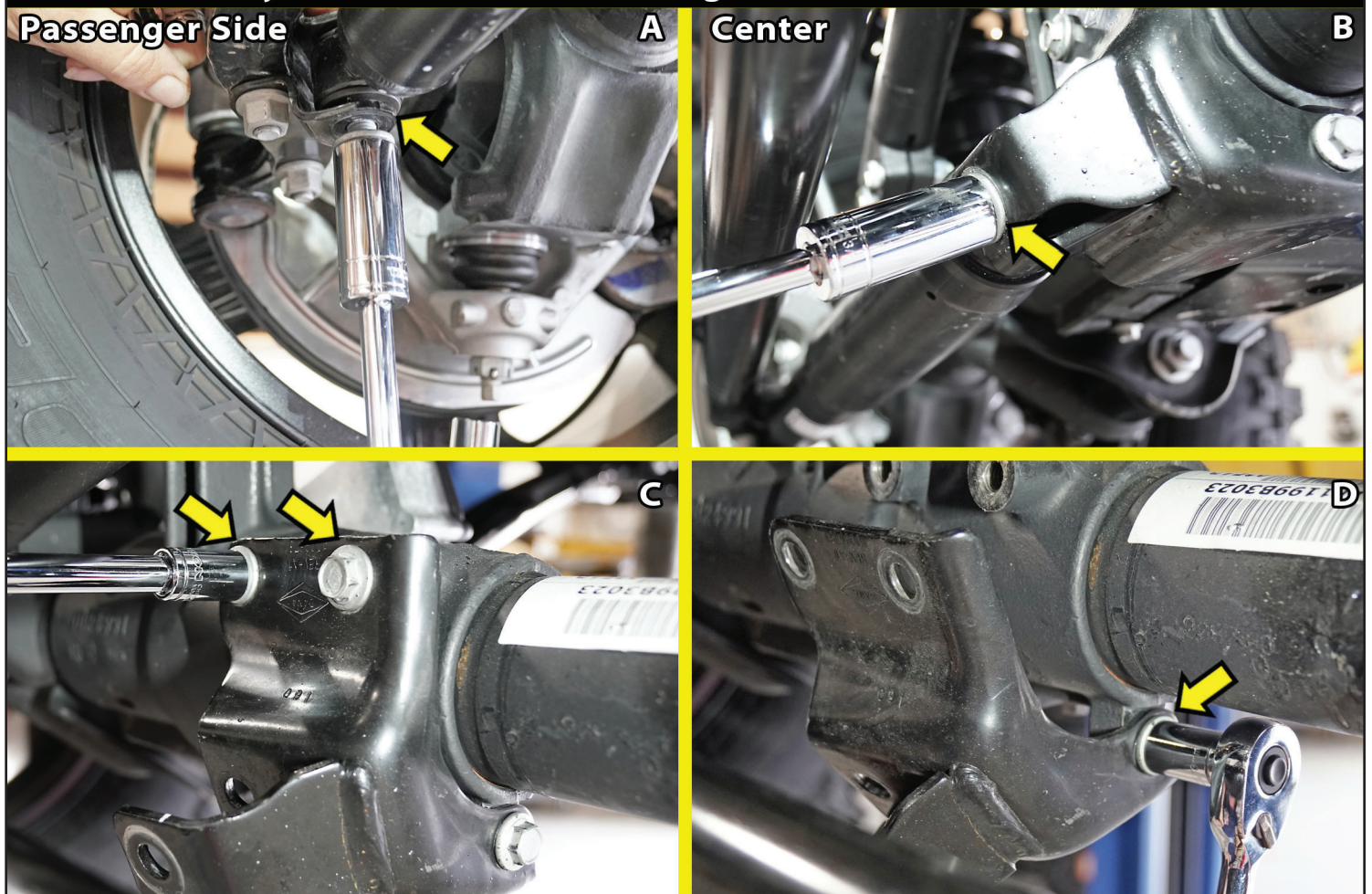

### 3. REMOVE FACTORY STABILIZER MOUNT FROM TIE ROD...

**NOTE:** While not necessary to install the new SUPERLIFT Dual Steering Stabilizer mount, you can remove the factory stabilizer mounting bracket.

**[Illustration 2-A]** Remove the two (2) factory bolts/nuts from the tie rod end stabilizer mount. [18]

**[Illustration 2-B]** Remove the factory hardware from the tie rod stabilizer mount.

**[Illustration 2-C]** Remove the tie rod retaining nut. [21mm] Reinstall the nut a couple of turns by hand.

Use a Tie Rod Puller to separate the tie rod from the knuckle.

**TECH TIP** If you do not have a puller, you can use the method of striking the knuckle near the ball joint end to dislodge the knuckle. Strike the knuckle portion only.

**[Illustration 2-D]** Remove the factory stabilizer mount from the tie rod. Reattach the tie rod end to the knuckle and tighten. [21mm] (44)

### Illustration 2

#### Remove Factory Stabilizer & Tie Rod Mounting Bracket...

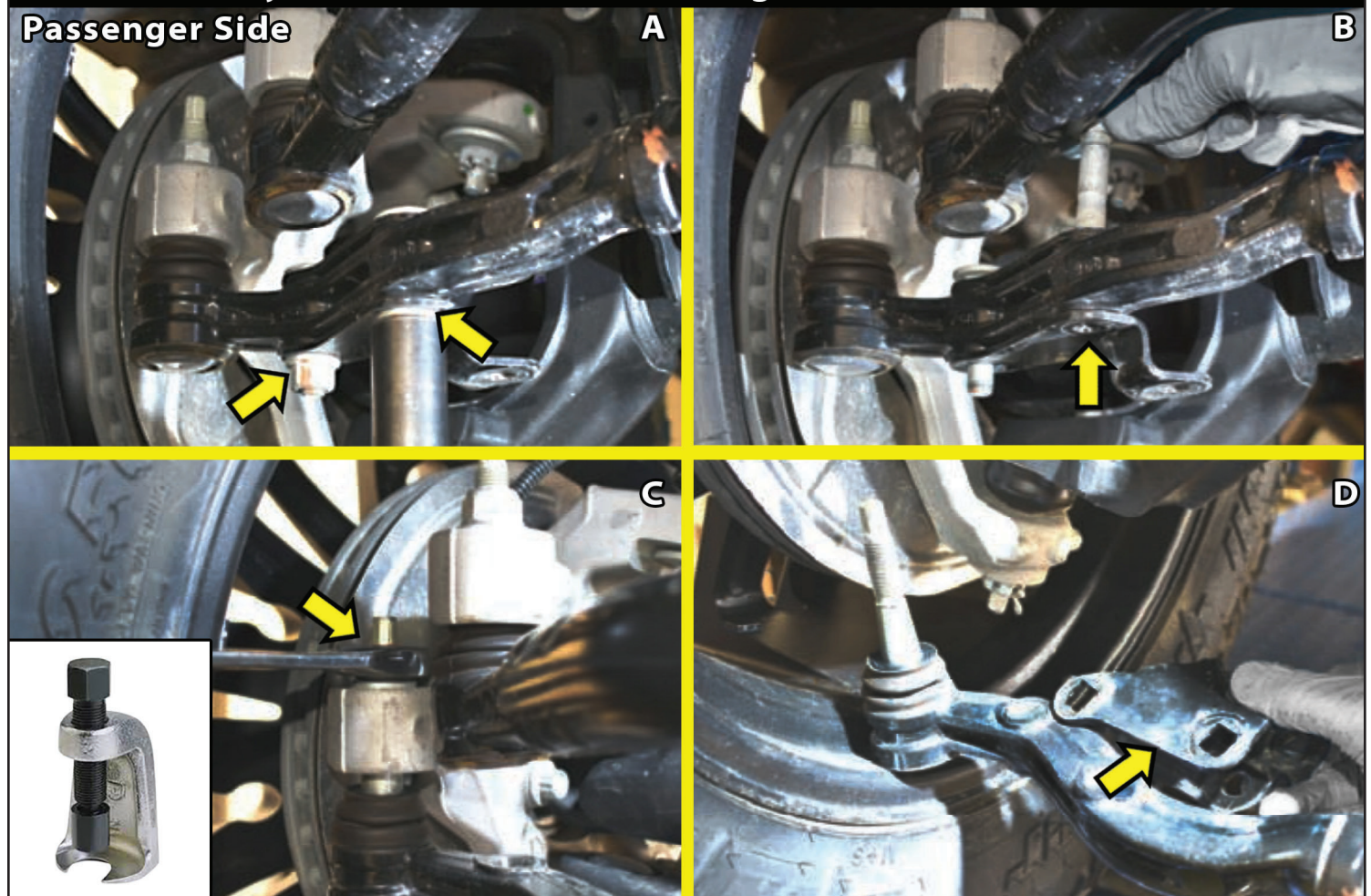

### 4. INSTALL DUAL STABILIZER MOUNT AT AXLE CENTER...

Locate the SUPERLIFT #55-01-5800 Stabilizer Center Bracket.

Locate Hardware Bag #77-92715. Hardware PER Bracket: (1) 1/2" x 2-7/8" x 5" U-Bolt, (2) 1/2"-20 Hi Nuts, (2) 1/2" F436 Carbon Washers & (2) 1/2"x2-3/4" Carriage Bolts, Coarse Thread, Grade 5.

**[Illustration 3-A]** Install the supplied 1/2" x 2-7/8" x 5" U-Bolt on the axle beside the front differential. Insert u-bolt from rear-to-front into #55-01-5800 center bracket. Place 1/2" F436 Carbon Washers onto u-bolt and loosely attach with 1/2"-20 Hi Nuts. [3/4"] **NOTE:** The stabilizer's mounting tab must be above the tie rod. The Driver side edge of the bracket should be placed against the differential housing.

☐ **[Illustration 3-B]** Insert two (2) 1/2" x 2-3/4" Carriage Bolts up through the stabilizer center bracket at the front stabilizer mounting tab. Position bracket & carriage bolts above the tie rod.

☐ **[Illustration 3-C]** Install the two (2) factory bolts into the stabilizer center bracket at the factory axle mounts. Tighten into place. [13mm] (59)

☐ **[Illustration 3-D]** Tighten u-bolt. [3/4"] (52)

### Illustration 3

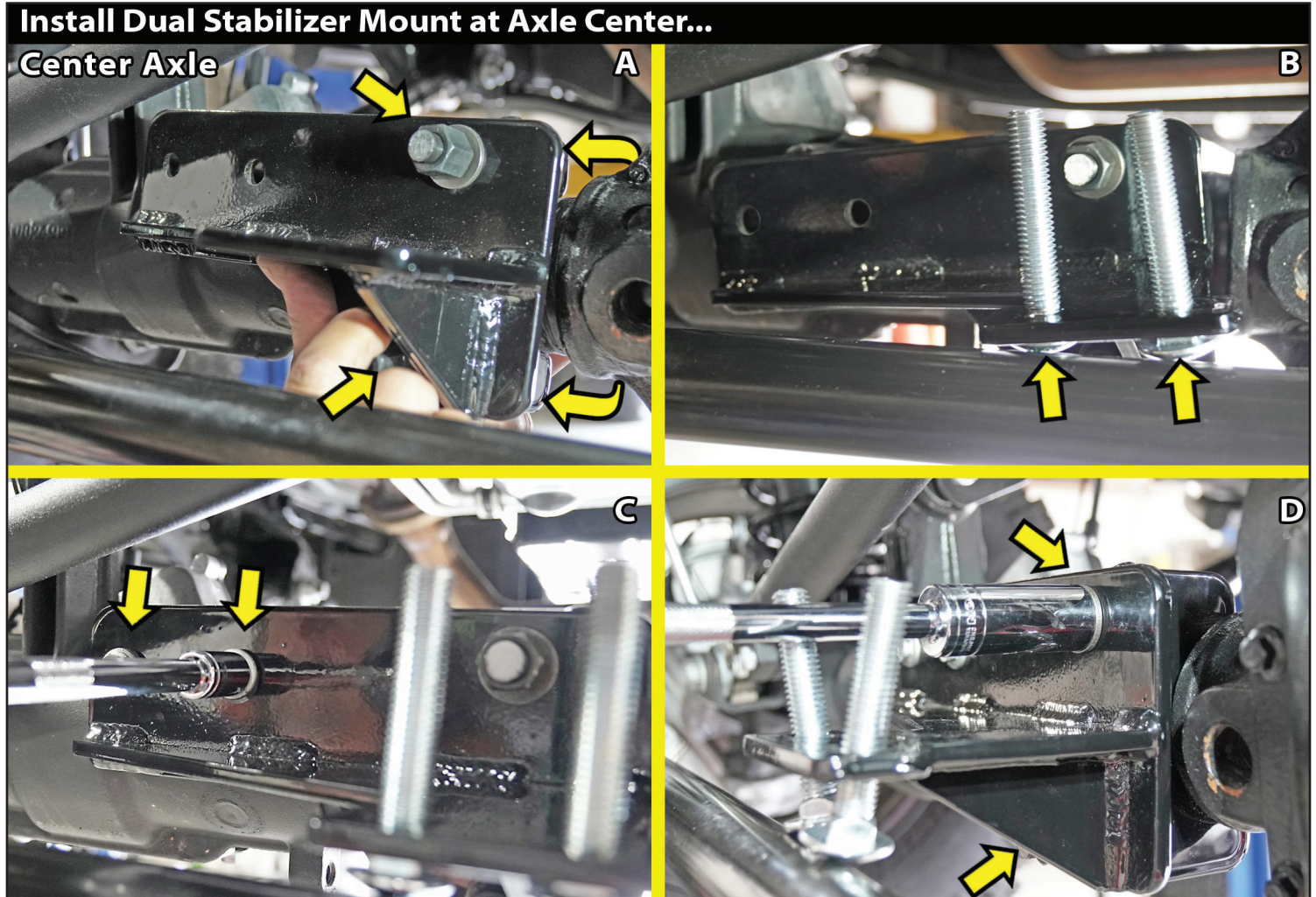

### 5. INSTALL STABILIZER TIE ROD BRACKETS...

Locate the #55-03-5800 Driver Side, Outside Bracket & #55-04-5800 Passenger Side, Outside Bracket. These Brackets Are Side Specific.

Locate Hardware Bag #77-92715. Hardware PER Bracket: (2) 5/16" x 1-5/8" x 2-1/4" U-Bolts, (4) 5/16" Flange Nuts, Coarse Thread, Grade 5 & (1) 1/2" x 2-3/4" Carriage Bolt, Coarse Thread, Grade 5.

**⚠ NOTE:** The 1/2" carriage bolt must be in position before the bracket is attached to the tie rod. The bolt cannot be installed after installing the bracket. The bracket is positioned behind the tie rod as shown.

☐ **[Illustration 4-A]** Install the 1/2" x 2-3/4" Carriage Bolt into the #55-04-5800 Passenger Side tie rod bracket. Place the tie rod bracket on the rear of tie rod. Install the (2) 5/16" x 1-5/8" x 2-1/4" U-Bolts going from front-to-rear and secure with (4) 5/16" Flange Nuts. [1/2"] Do not tighten at this time.

☐ **[Illustration 4-B]** Repeat process on the driver side using the #55-03-5800 Driver Side bracket.

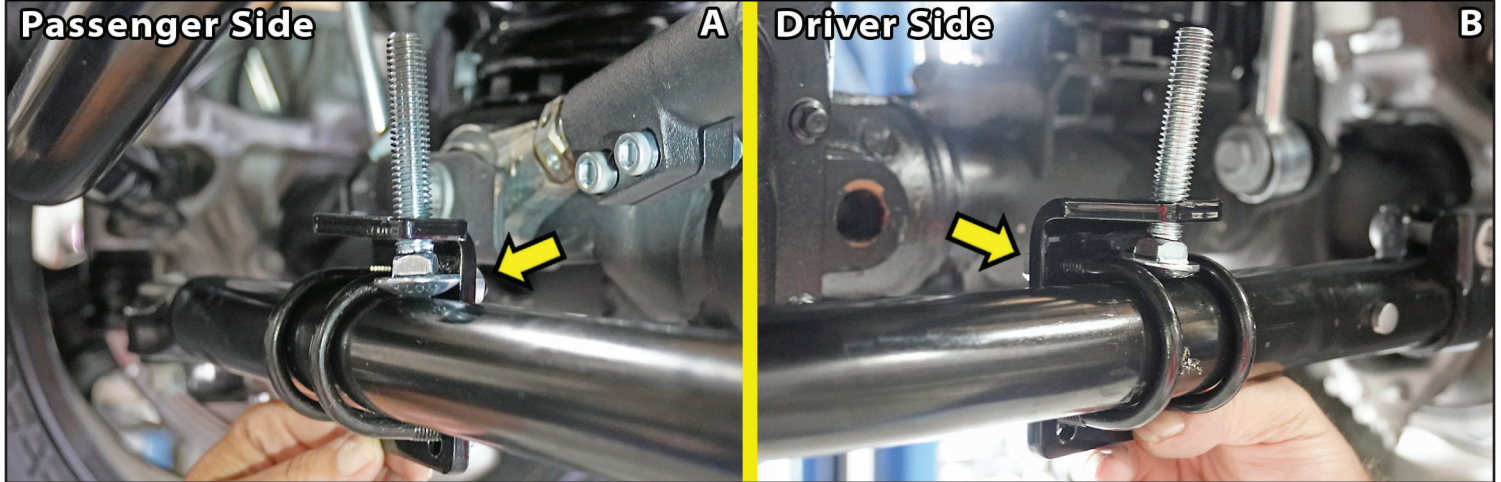
**Illustration 4****Install Stabilizer Tie Rod Brackets...****6. INSTALL STABILIZER CYLINDERS...**

Locate the two (2) # 24-158428 BILSTEIN Steering Stabilizers.

Locate Hardware Bag #77-92715. Hardware PER Stabilizer End: (2) 1/2" SAE Flat Washer & (1) 1/2" Nyloc Nut, Coarse Thread.

- [Illustration 4-A]** Place a 1/2" SAE Flat Washer onto the driver side carriage bolt at the stabilizer center bracket. Place the body end of the stabilizer onto the carriage bolt. Place a 1/2" SAE Flat Washer onto the carriage bolt and attach with a 1/2" Nyloc Nut. [3/4"] Secure, but do not tighten.
- Repeat process on the passenger side of the stabilizer center bracket.
- [Illustration 4-B]** Position the tie rod brackets so that the center-eye-to-center-eye dimension of each cylinder will be 16-7/16" for BILSTEIN cylinders.
- [Illustration 4-C]** Place the rod end of the stabilizer onto the carriage bolt. Place a 1/2" SAE Flat Washer onto the carriage bolt and attach with a 1/2" Nyloc Nut. Secure, but do not tighten. [3/4"] **NOTE:** Make sure that the top mounting tab of the stabilizer tie rod bracket is level and in-line with the center bracket mount.
- [Illustration 4-D]** Repeat process on the passenger side. [3/4"]
- Have an assistant cycle the steering lock-to-lock while you inspect the steering stabilizers' movement. Verify that the stabilizer operates smoothly and does not contact the steering linkage or other components. Also verify that the stabilizer does not "bottom" or "top" out, which will limit the steering before it contacts the steering stops. It may be necessary to adjust the position of the tie rod bracket until the necessary clearance / travel is achieved.
- NOTE:** On vehicle with a 1.5-2" suspension, it may be necessary to adjust the drag link collar to allow for clearance between the pinch bolts and the cylinders.
- Once the the check is complete, tighten tie rod brackets into position. [1/2"] (30) Tighten stabilizer cylinder to tie rod bracket. [3/4"] (65)
- Tighten stabilizer cylinders to center bracket mounts. [3/4"] (65)

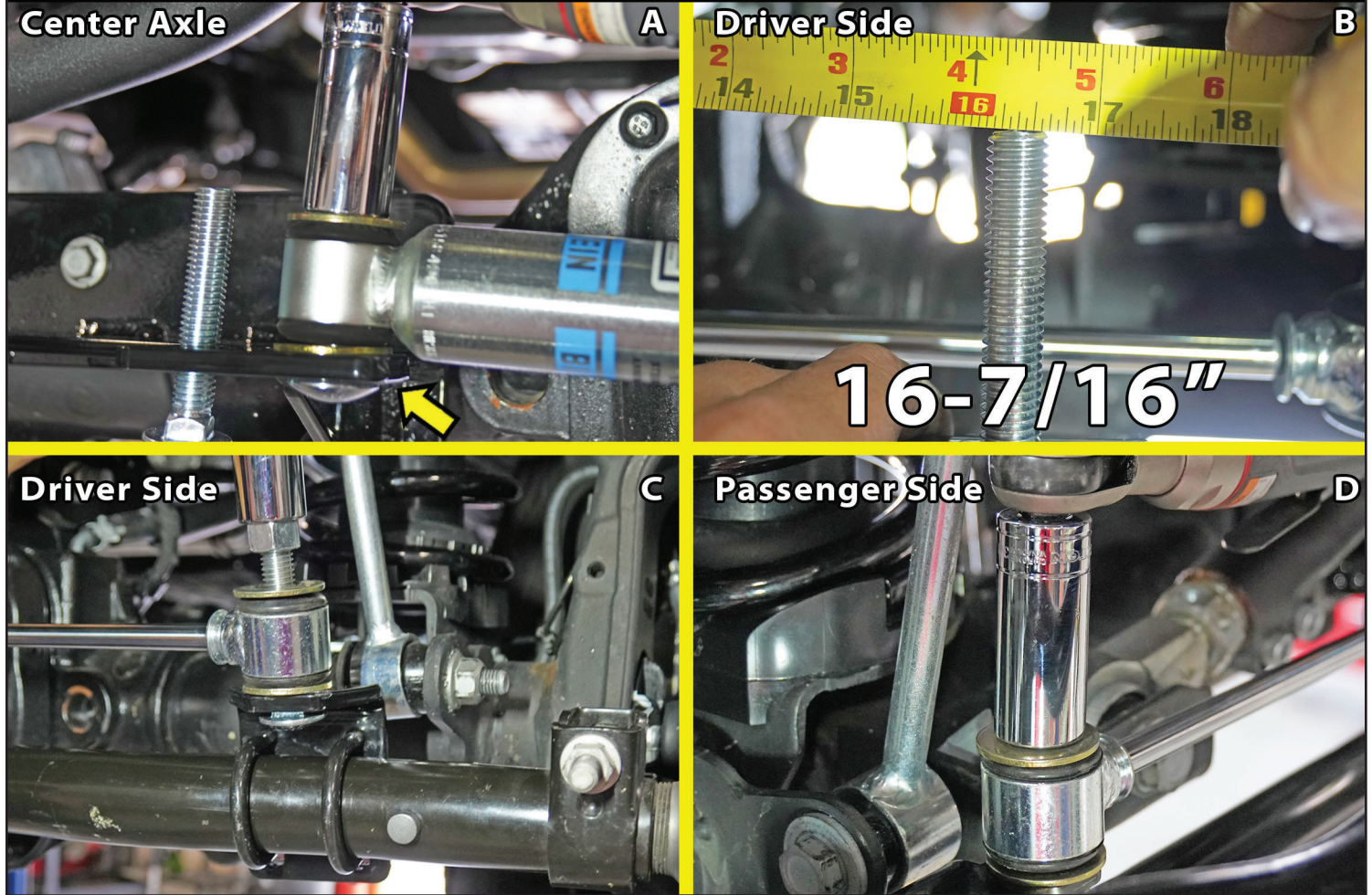
**Illustration 5****Install Stabilizer Cylinders...****7. FINAL CLEARANCE and TORQUE CHECK...**

Cycle steering lock-to-lock and inspect the tires / wheels, and the steering, suspension, and brake systems for proper operation, tightness, and adequate clearance.

**IMPORTANT MAINTENANCE INFORMATION**

**⚠️ WARNING:** It is the ultimate buyer's responsibility to have all bolts / nuts checked for tightness after the first 100 miles and then every 1000 miles. The steering, suspension and driveline systems, plus wheel alignment should be inspected by a qualified professional mechanic at least every 3000 miles.

**LIMITED LIFETIME WARRANTY / WARNINGS**

Your SUPERLIFT® product is covered by the Limited Warranty explained below that gives you specific legal rights. This limited warranty is the only warranty SUPERLIFT® makes in connection with your product purchase. SUPERLIFT® neither assumes nor authorizes any retailer or other person or entity to assume for it any other obligation or liability in connection with this product or limited warranty.

**SUPERLIFT, LLC, LIMITED LIFETIME WARRANTY**

**What is covered?** Subject to the terms below, SUPERLIFT® will repair or replace its products found defective in materials or workmanship for so long as the original purchaser owns the vehicle on which the product was originally installed. Your warranter is SUPERLIFT, LLC, doing business as SUPERLIFT® Suspension Systems ("SUPERLIFT®").

**What is not covered?** Your SUPERLIFT® Limited Warranty does not cover products SUPERLIFT® determines to have been damaged by or subjected to:



- Alteration, modification or failure to maintain.
- Normal wear and tear (bushings, rod ends, etc.). Scratches or defects in product finishes (powder coating, plating, etc.).
- Damage to, or resulting from, the vehicle's electronic stability system, related components or other vehicle systems.
- Racing or other vehicle competitions or contests. Accidents, impact by rocks, trees, obstacles or other aspects of the environment.
- Theft, vandalism or other intentional damage.

Remedy Limited to Repair or Replacement. The exclusive remedy provided hereunder shall, upon SUPERLIFT's inspection and at SUPERLIFT's option, be either repair or replacement of the product covered under this Limited Warranty. Customers requesting warranty consideration should contact SUPERLIFT® by phone (1-800-551-4955) to obtain a Returned Goods Authorization number. All removal, shipping and installation costs are customer's responsibility.

If a replacement part is needed before the SUPERLIFT® part in question can be returned, you must first purchase the replacement part. Then, if the part in question is deemed warrant-able, you will be credited / refunded.

#### **OTHER LIMITATIONS - EXCLUSION OF DAMAGES - YOUR RIGHTS UNDER STATE LAW**

- Neither SUPERLIFT® nor your independent SUPERLIFT® dealer are responsible for any time loss, rental costs, or for any incidental, consequential or other damages you may have.
- This Limited Warranty gives you specific rights, and this is the only warranty SUPERLIFT® makes in connection with your product purchase. You may also have other rights that vary from state to state. For example, while all implied warranties are disclaimed herein, any implied warranty required by law is limited to the terms of our Limited Lifetime Warranty as described above. Some states do not allow limitations of how long an implied warranty lasts and / or do not allow the exclusion or limitation of incidental or consequential damages, so the limitations and exclusions herein may not apply to you. SUPERLIFT® neither assumes nor authorizes any retailer or other person or entity to assume for it any other obligation or liability in connection with this product or Limited Warranty.

#### **WE WANT TO SEE YOUR RIDE...**

Grab photos of your SUPERLIFT Equipped truck in various poses and in action.

Email pictures to us at [sales@superlift.com](mailto:sales@superlift.com)

Tag us on **Facebook**: [@superlift suspension systems](https://www.facebook.com/superlift_suspension_systems)

Tag us on **Instagram**: [#superlift](https://www.instagram.com/superlift), [#superliftsuspension](https://www.instagram.com/superliftsuspension), [#superliftequipped](https://www.instagram.com/superliftequipped)

#### **THANKS For Choosing SUPERLIFT...**

For questions, technical support and warranty issues relating to this SUPERLIFT products, please contact SUPERLIFT directly.

**SUPERLIFT SUSPENSION**  
**300 Huey Lenard Loop Rd.**  
**West Monroe, Louisiana 71292**  
**Phone: (318) 397-3000**  
**Sales / Tech: (800) 551-4955**  
**Fax: (318) 397-3040**  
**SUPERLIFT.COM**